

**CITY CAMPUS**  
HAMBURG

# FLOOR PLANS

**BUILDING B, AVAILABLE SPACE: 10.475 SQ M**

## GROUND FLOOR BUILDING B

ADDRESS Amsinckstraße 71

FLOOR Ground floor

SPACE 500 sq m

-  Lobby
-  Restaurant

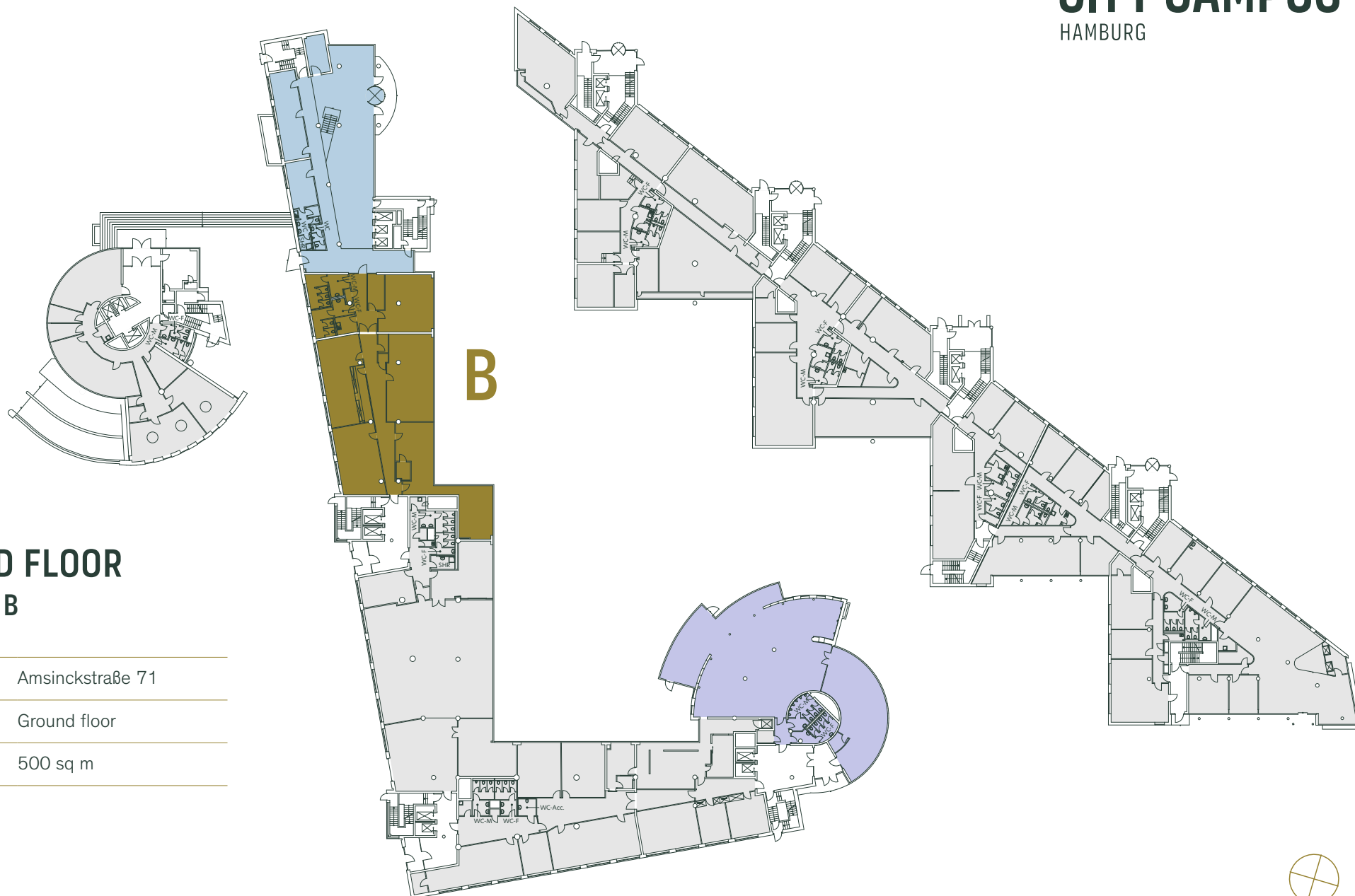

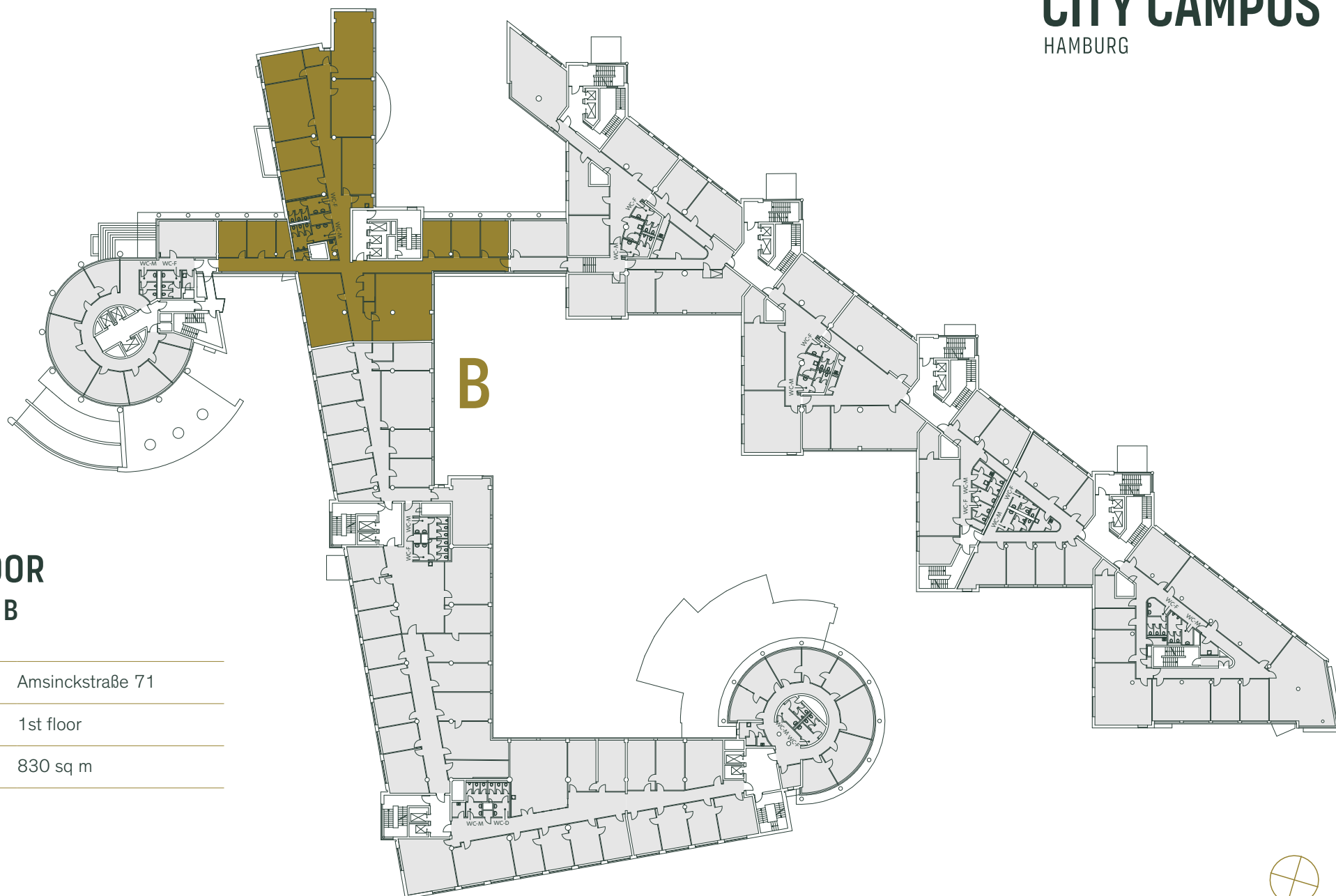

## 1ST FLOOR BUILDING B

ADDRESS Amsinckstraße 71

FLOOR 1st floor

SPACE 830 sq m





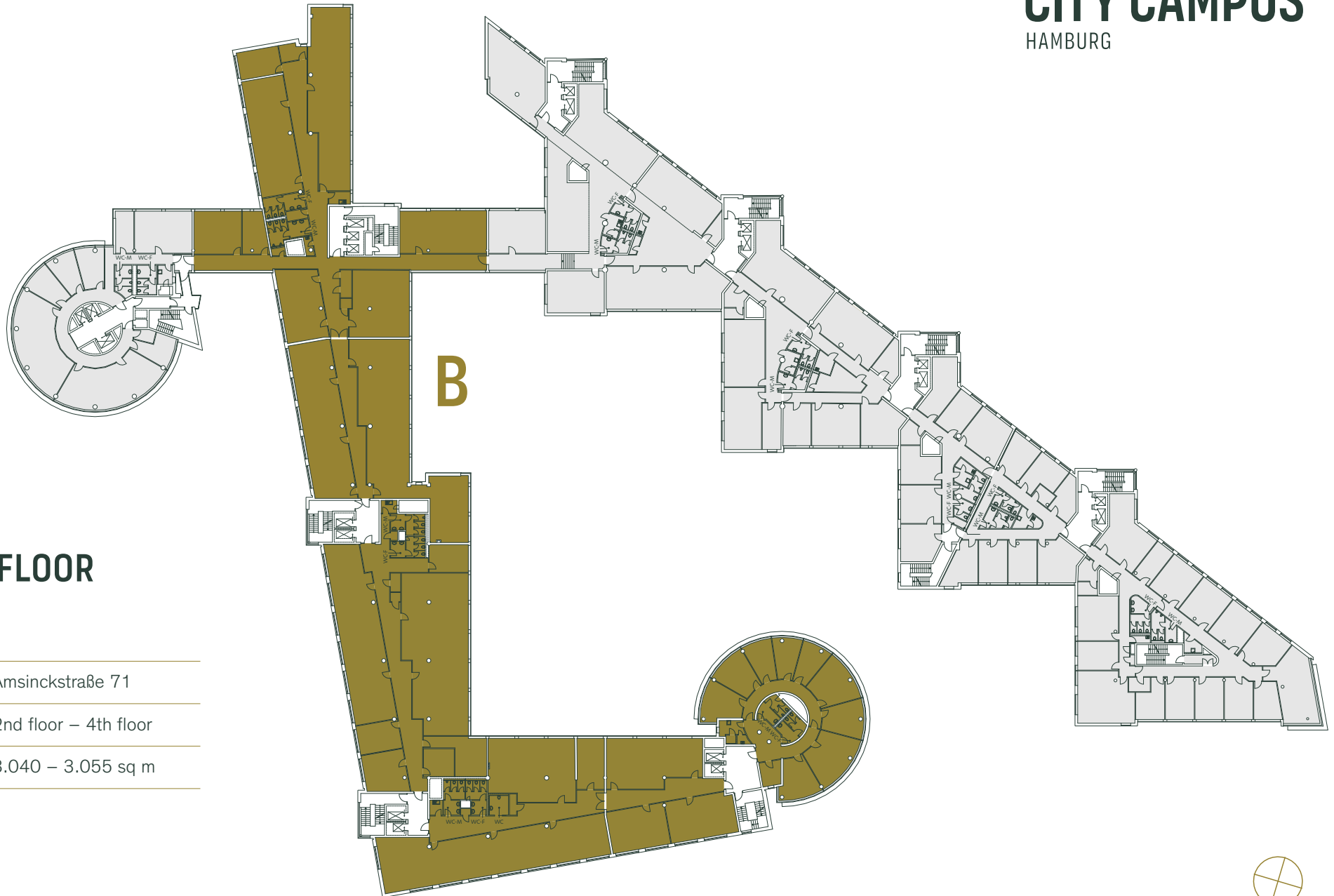

## TYPICAL FLOOR BUILDING B

ADDRESS	Amsinckstraße 71
FLOOR	2nd floor – 4th floor
SPACE	3.040 – 3.055 sq m

