

**CITY CAMPUS**  
HAMBURG



# FLOOR PLANS

**BUILDING A1, AVAILABLE SPACE: 5.115 SQ M**

A1

## GROUND FLOOR BUILDING A

BUILDING	A1
ADDRESS	Amsinckstraße 69
FLOOR	Ground floor
SPACE	600 sq m

-  Lobby
-  Restaurant

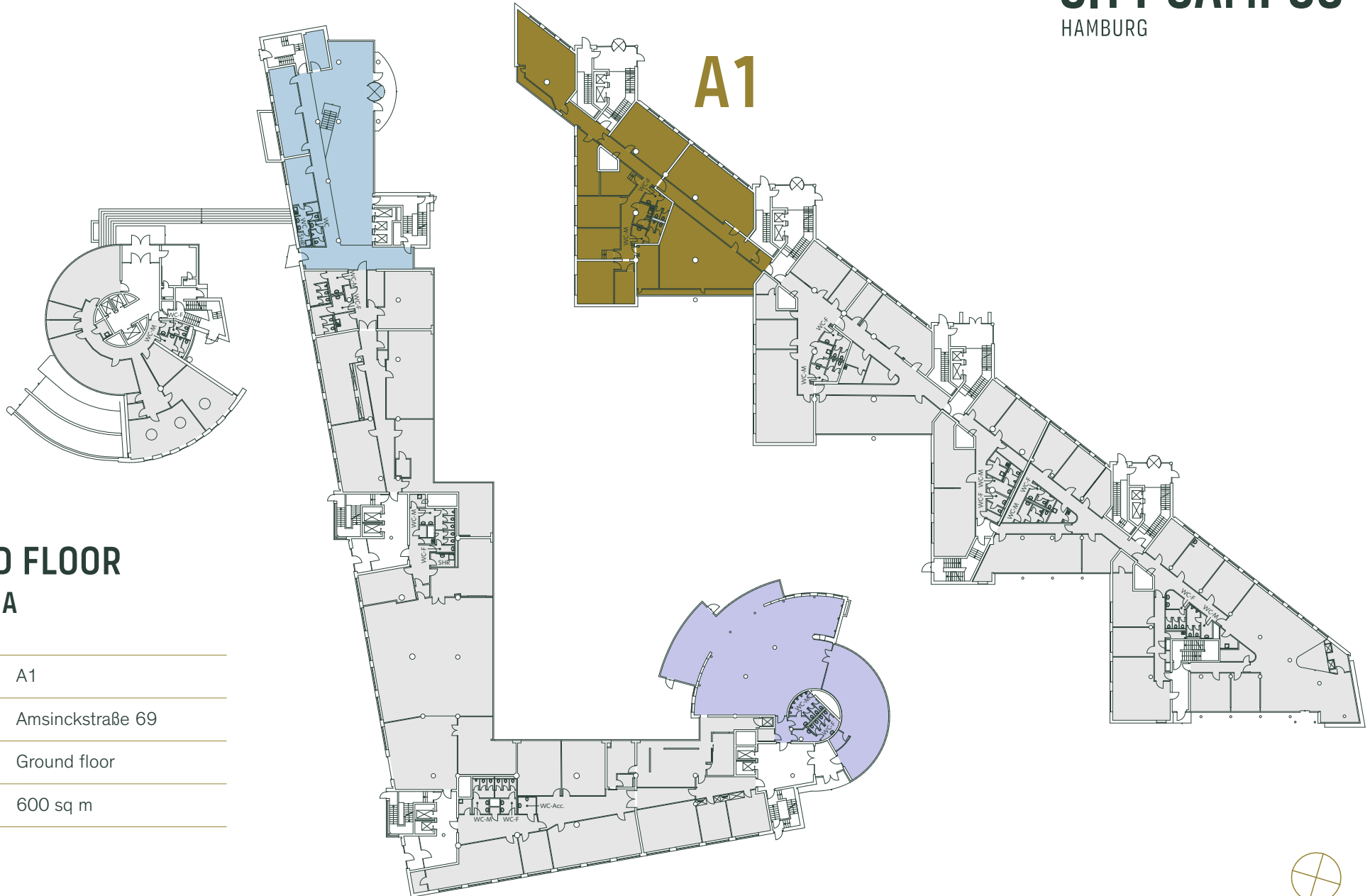

A1

## TYPICAL FLOOR BUILDING A

BUILDING	A1
ADDRESS	Amsinckstraße 69
FLOOR	1st floor – 5th floor
SPACE	660 – 730 sq m

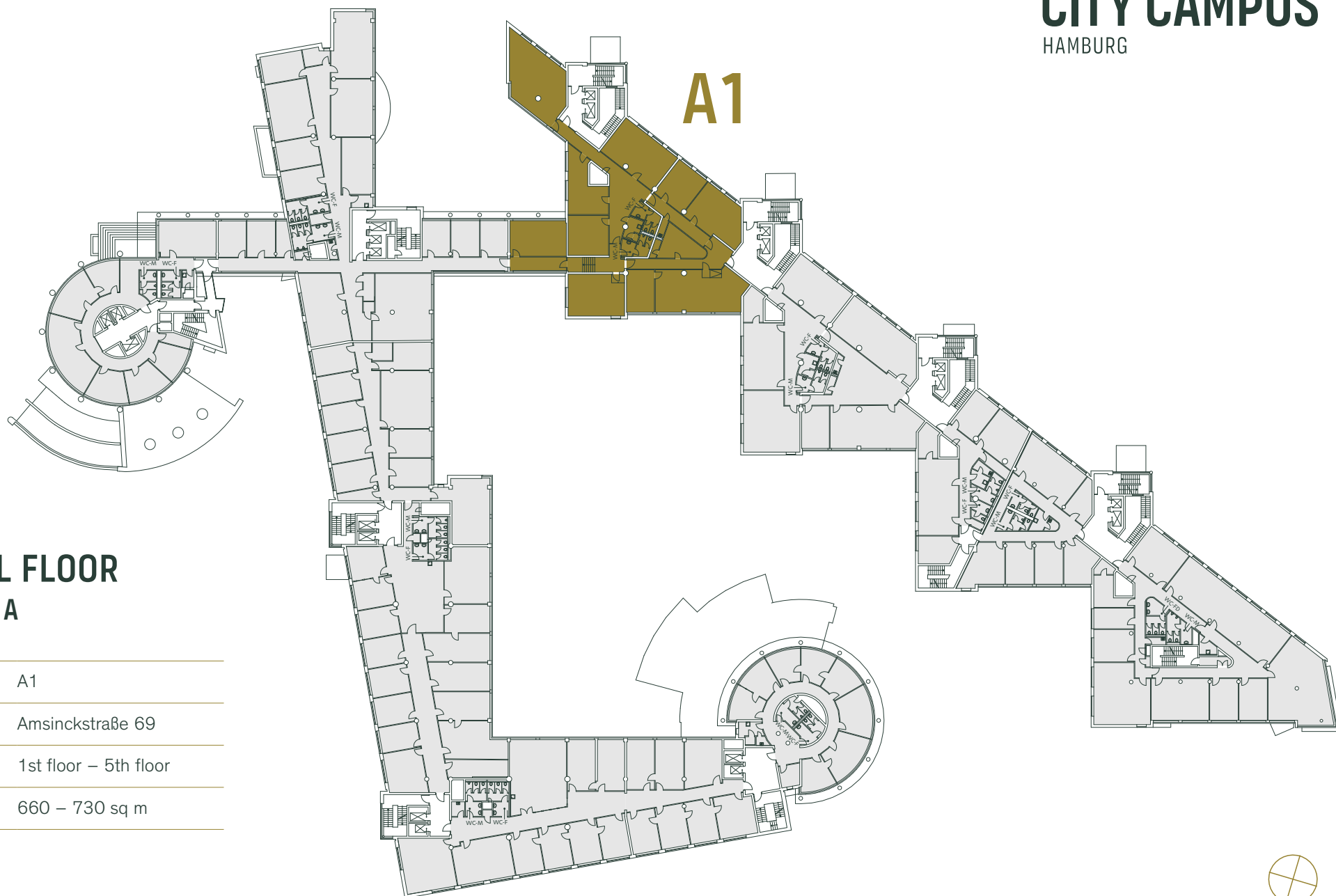



A1

## 6TH FLOOR BUILDING A

BUILDING	A1
ADDRESS	Amsinckstraße 69
FLOOR	6th floor
SPACE	655 sq m

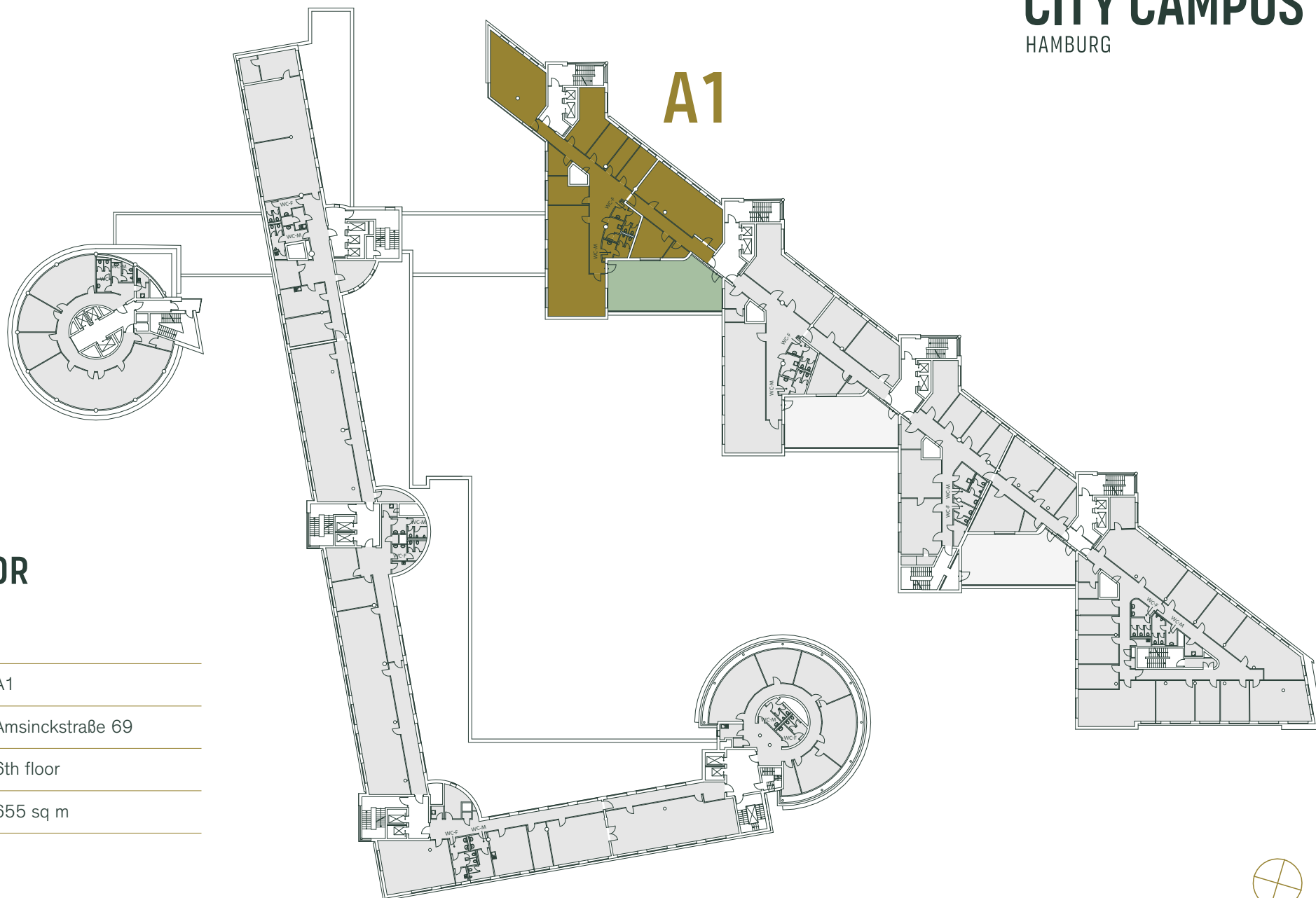

● Outdoor space



A1

## 7TH FLOOR BUILDING A

BUILDING	A1
ADDRESS	Amsinckstraße 69
FLOOR	7th floor
SPACE	240 sq m

● Outdoor space

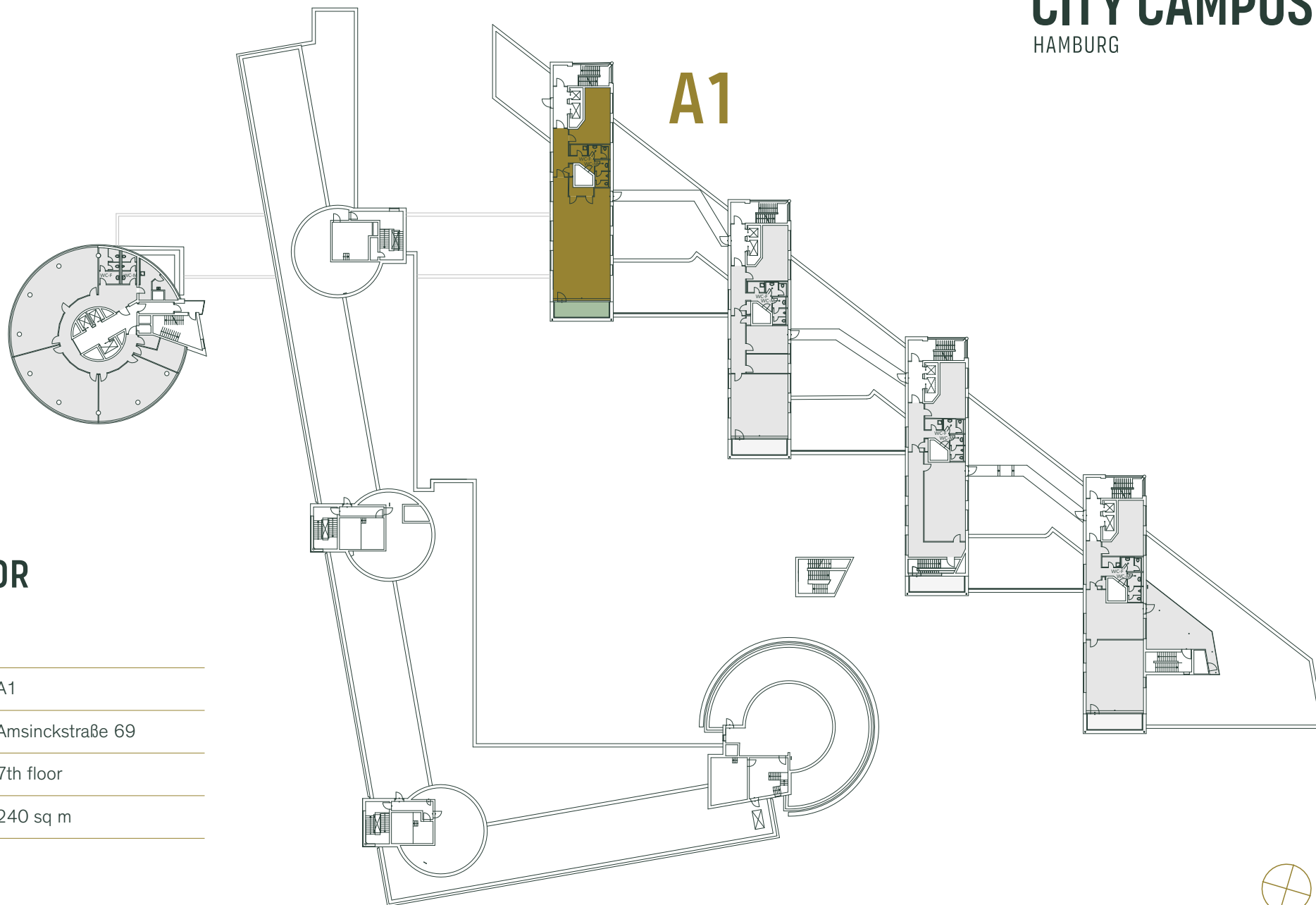

**CITY CAMPUS**  
HAMBURG

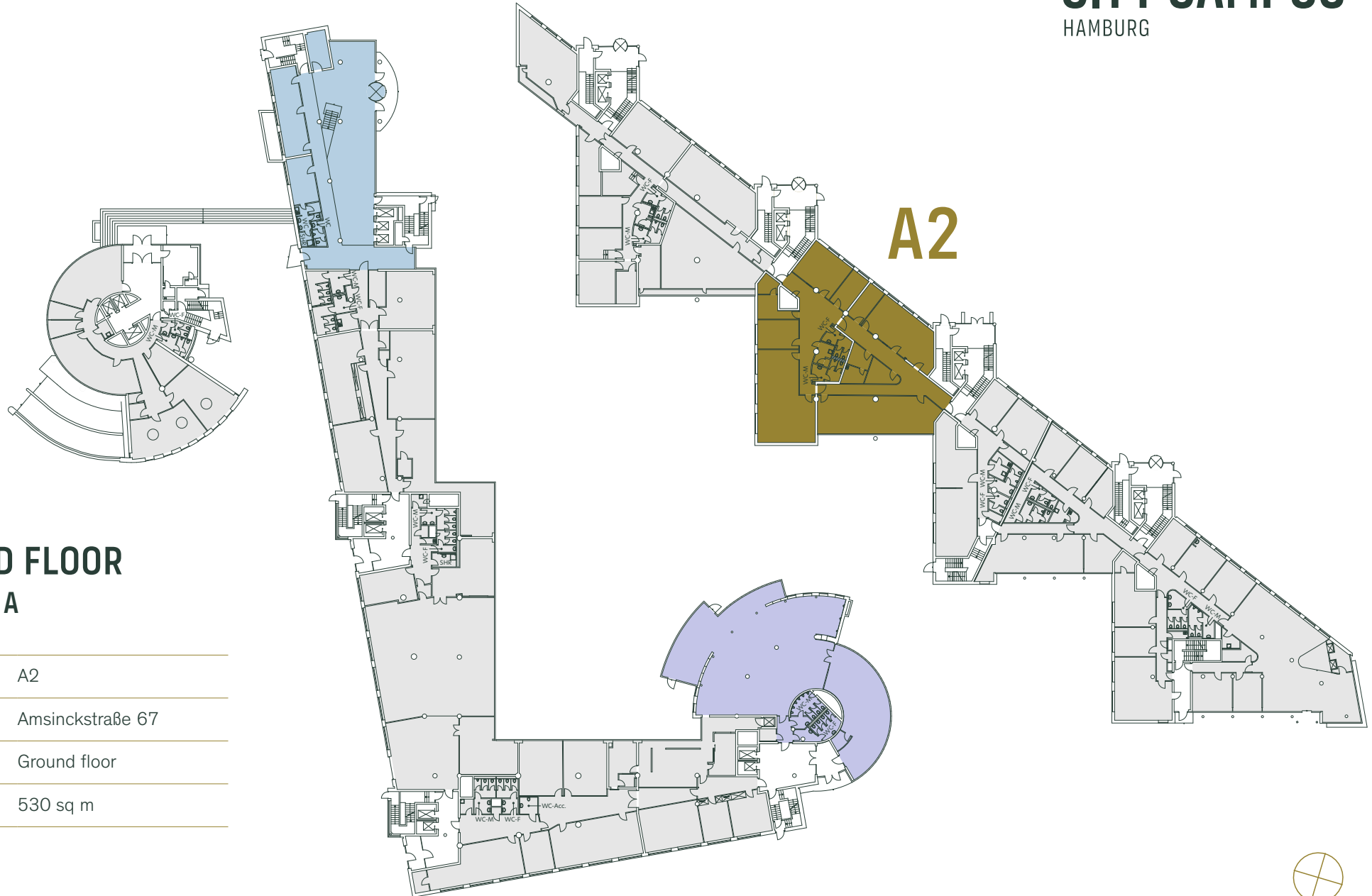

# FLOOR PLANS

**BUILDING A2, AVAILABLE SPACE: 4.010 SQ M**



## GROUND FLOOR BUILDING A

BUILDING	A2
ADDRESS	Amsinckstraße 67
FLOOR	Ground floor
SPACE	530 sq m

-  Lobby
-  Restaurant





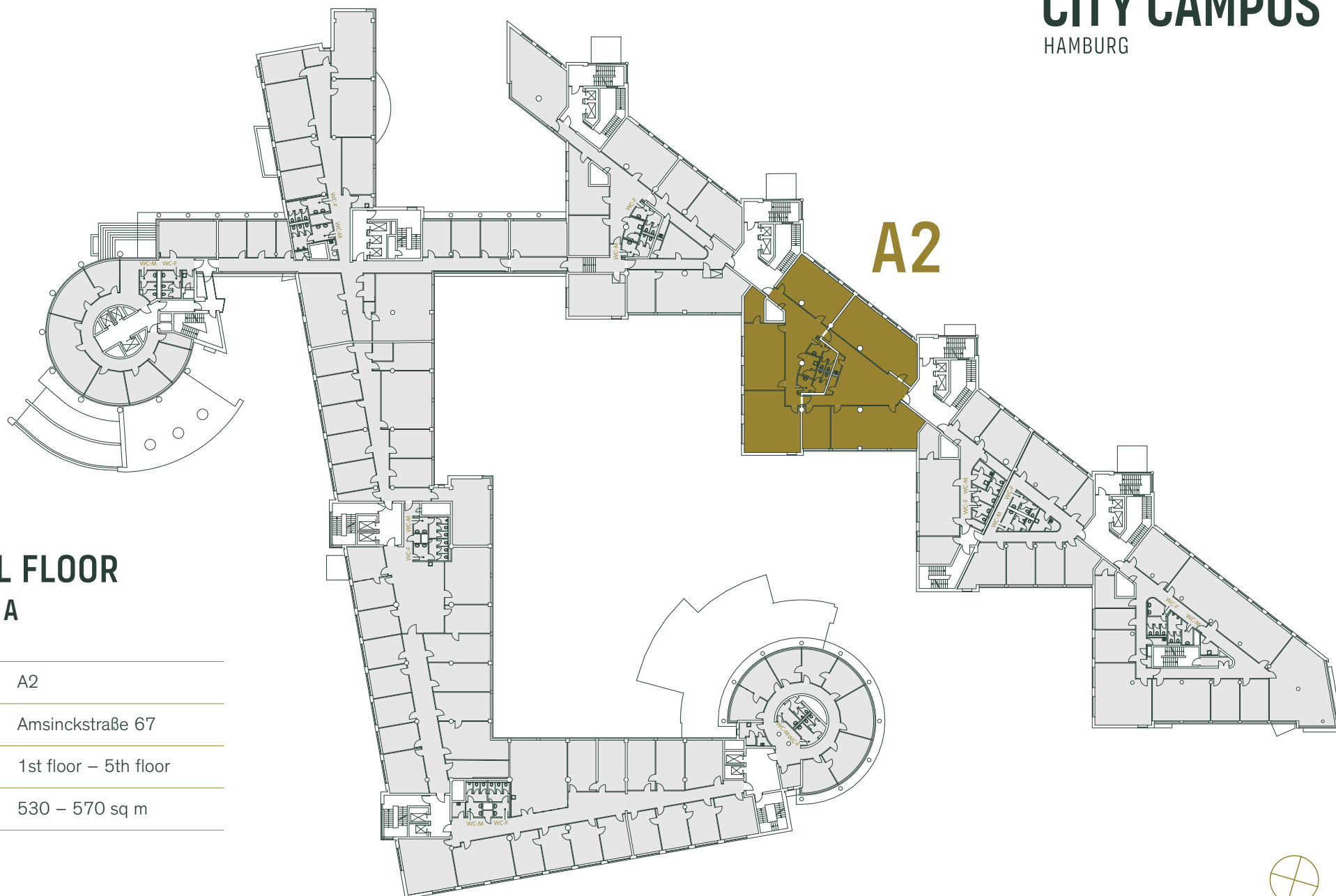

## TYPICAL FLOOR BUILDING A

BUILDING	A2
ADDRESS	Amsinckstraße 67
FLOOR	1st floor – 5th floor
SPACE	530 – 570 sq m





## 6TH FLOOR BUILDING A

BUILDING	A2
ADDRESS	Amsinckstraße 67
FLOOR	6th floor
SPACE	550 sq m

● Outdoor space

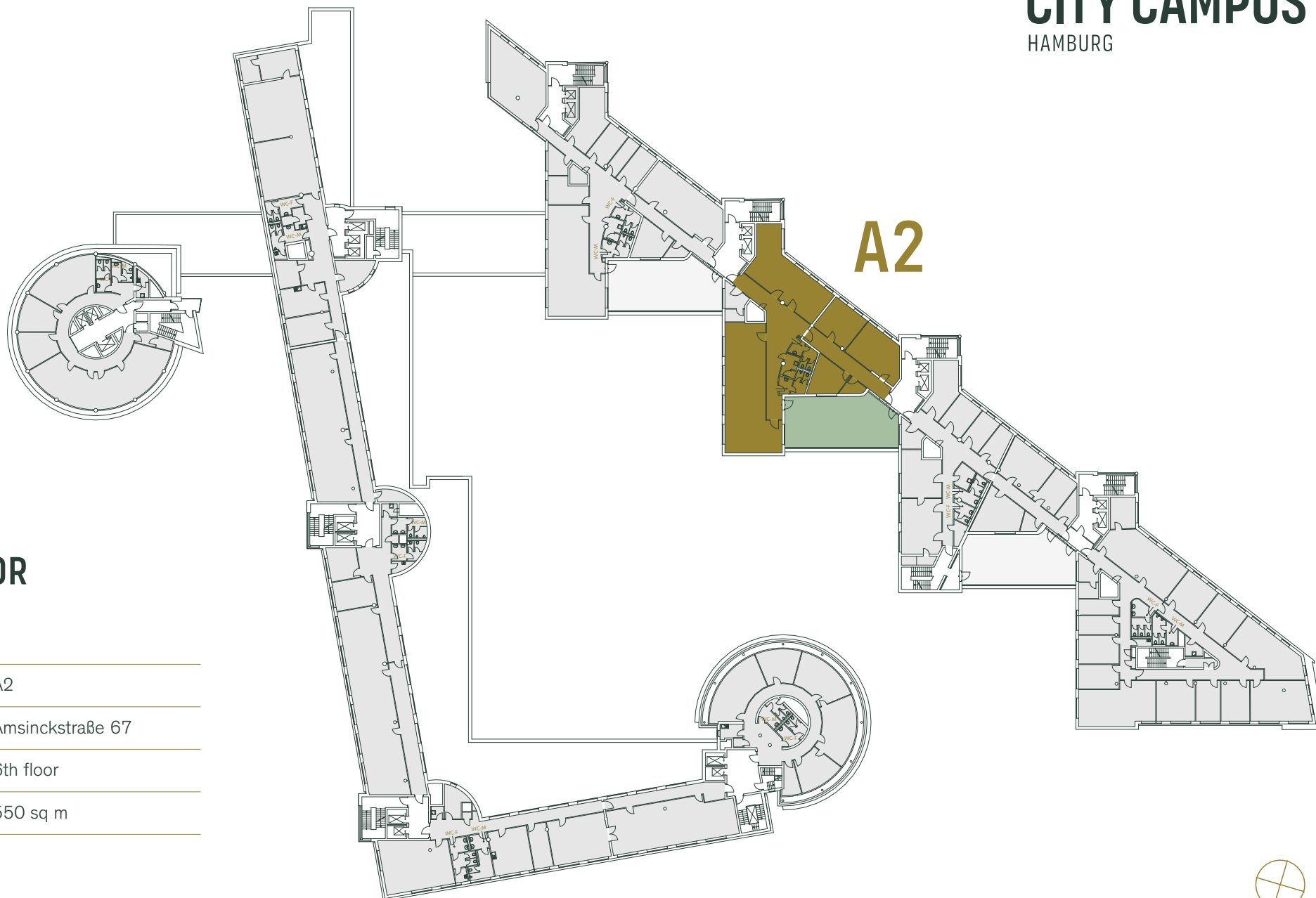

## 7TH FLOOR BUILDING A

BUILDING	A2
ADDRESS	Amsinckstraße 67
FLOOR	7th floor
SPACE	180 sq m

● Outdoor space

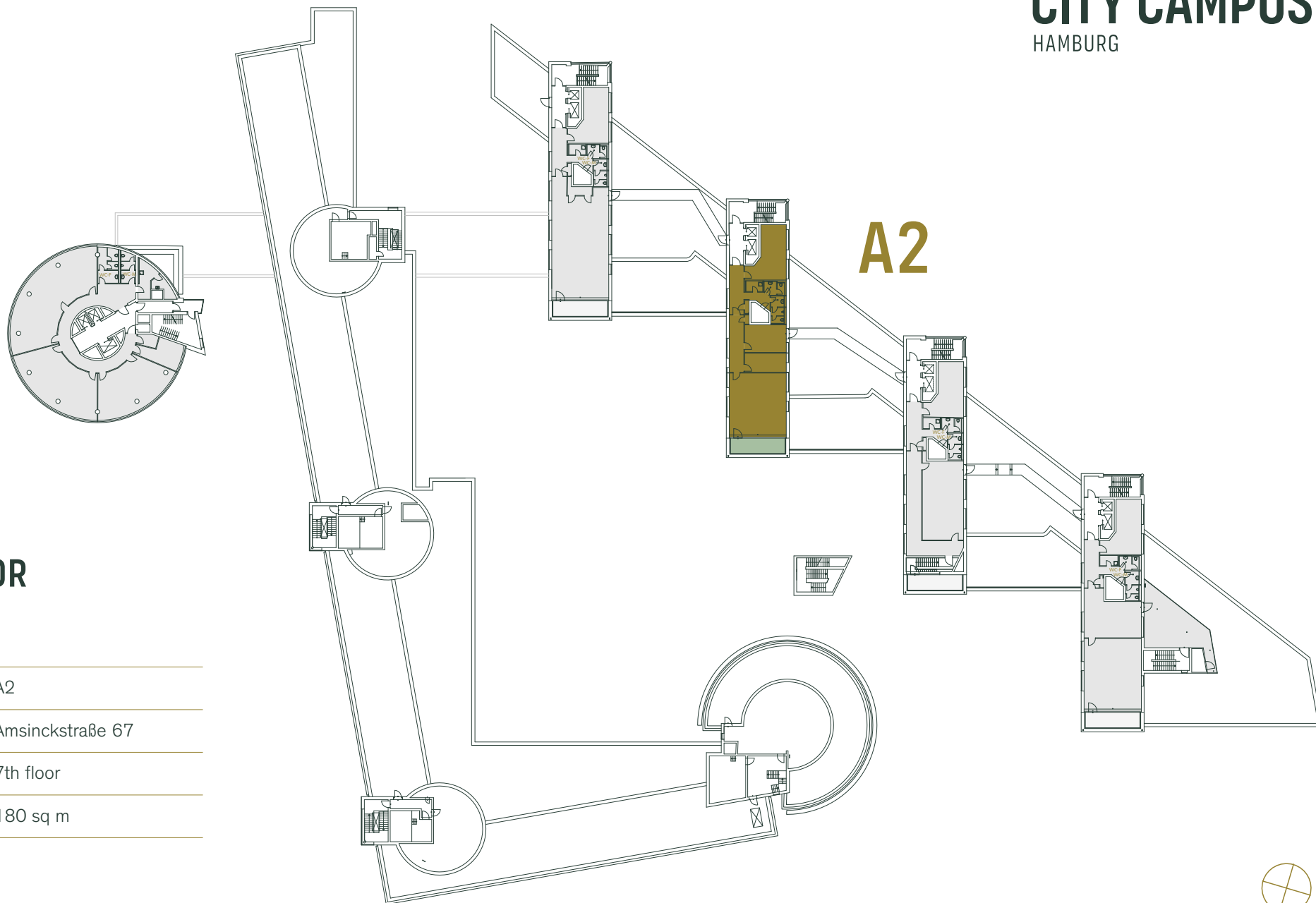

**CITY CAMPUS**  
HAMBURG

# FLOOR PLANS



**BUILDING A3, AVAILABLE SPACE: 4.280 SQ M**

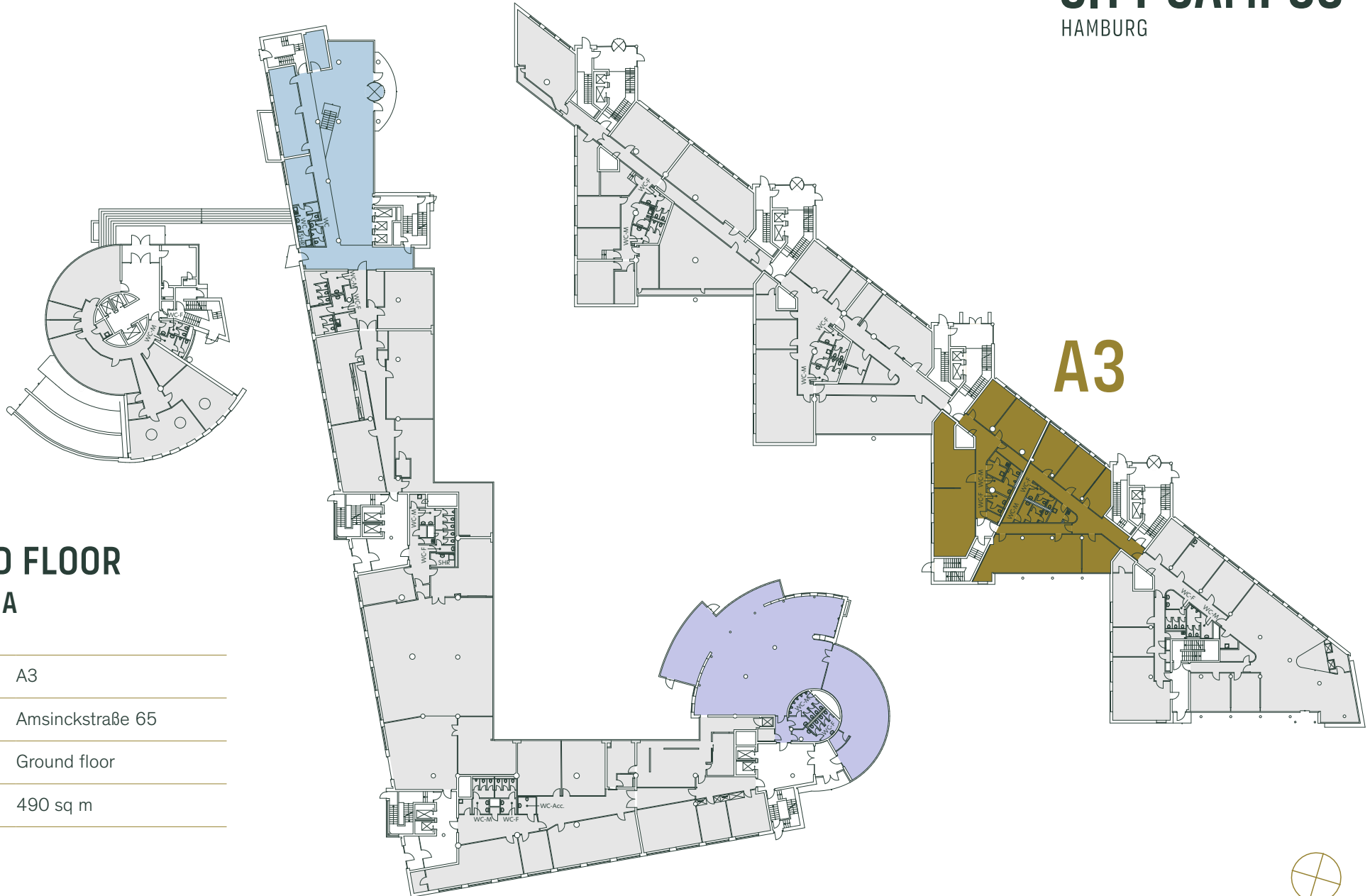



## GROUND FLOOR BUILDING A

BUILDING	A3
ADDRESS	Amsinckstraße 65
FLOOR	Ground floor
SPACE	490 sq m

-  Lobby
-  Restaurant



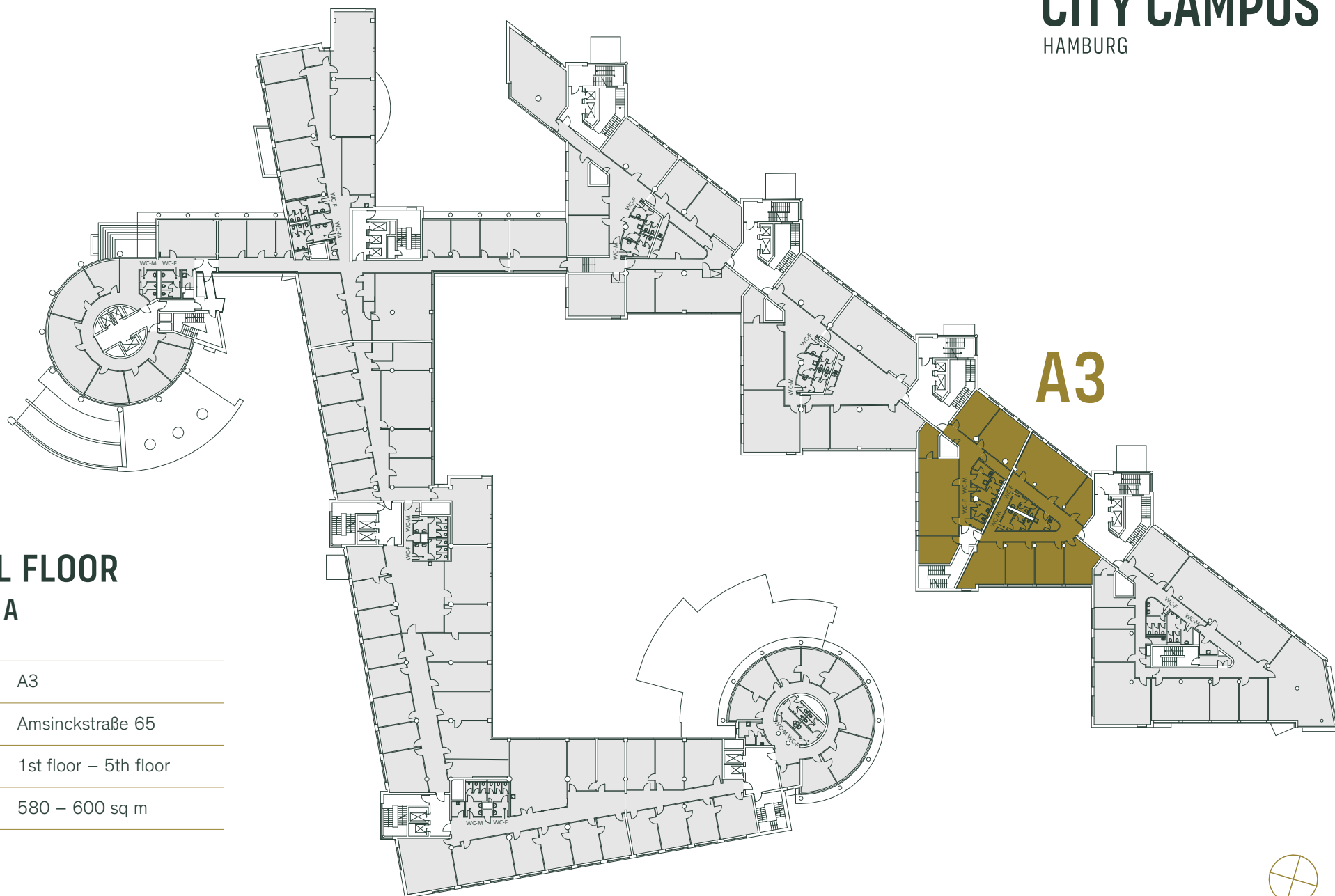

## TYPICAL FLOOR BUILDING A

BUILDING	A3
ADDRESS	Amsinckstraße 65
FLOOR	1st floor – 5th floor
SPACE	580 – 600 sq m



## 6TH FLOOR BUILDING A

BUILDING	A3
ADDRESS	Amsinckstraße 65
FLOOR	6th floor
SPACE	570 sq m

 Outdoor space

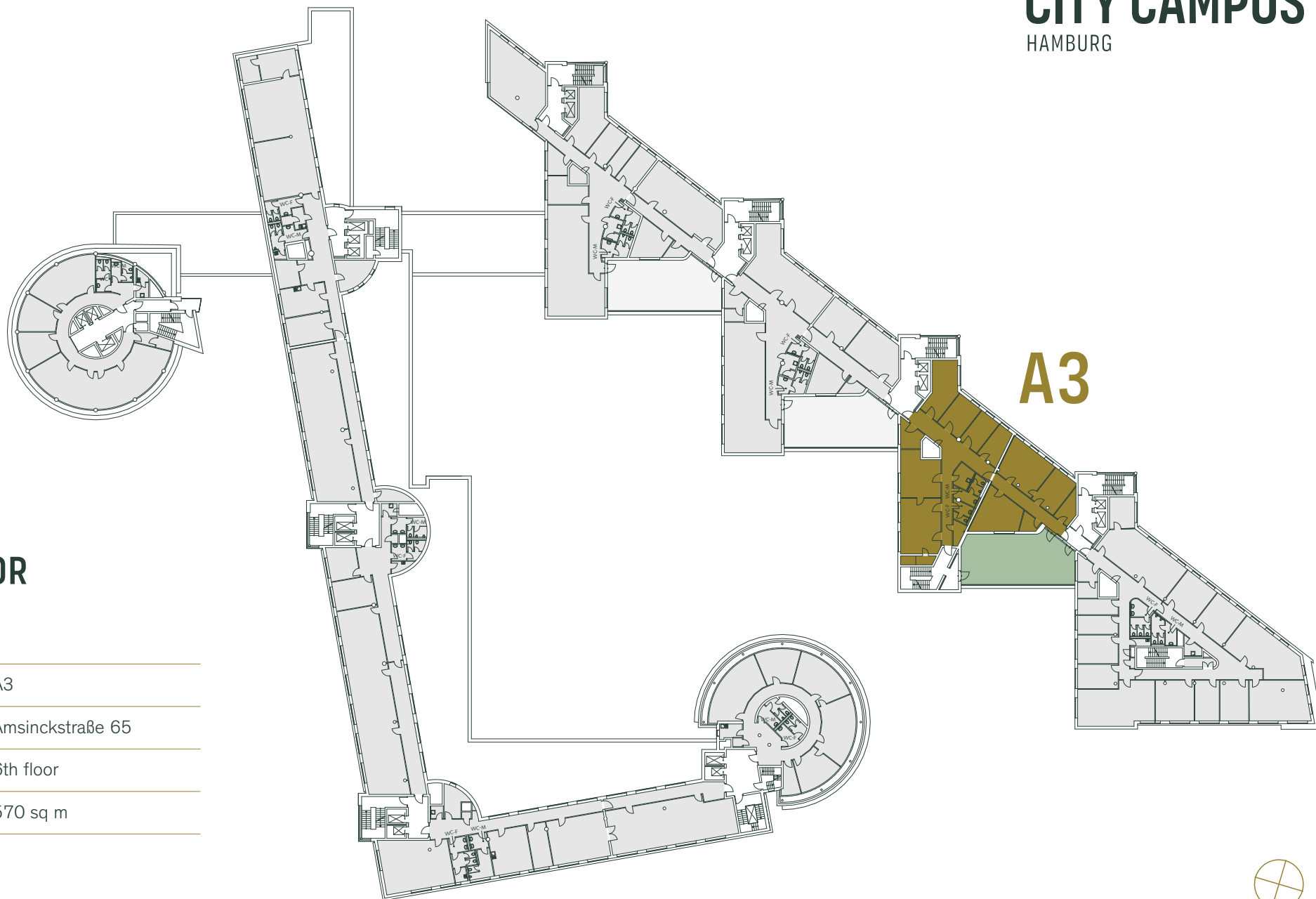



## 7TH FLOOR BUILDING A

BUILDING	A3
ADDRESS	Amsinckstraße 65
FLOOR	7th floor
SPACE	270 sq m

● Outdoor space

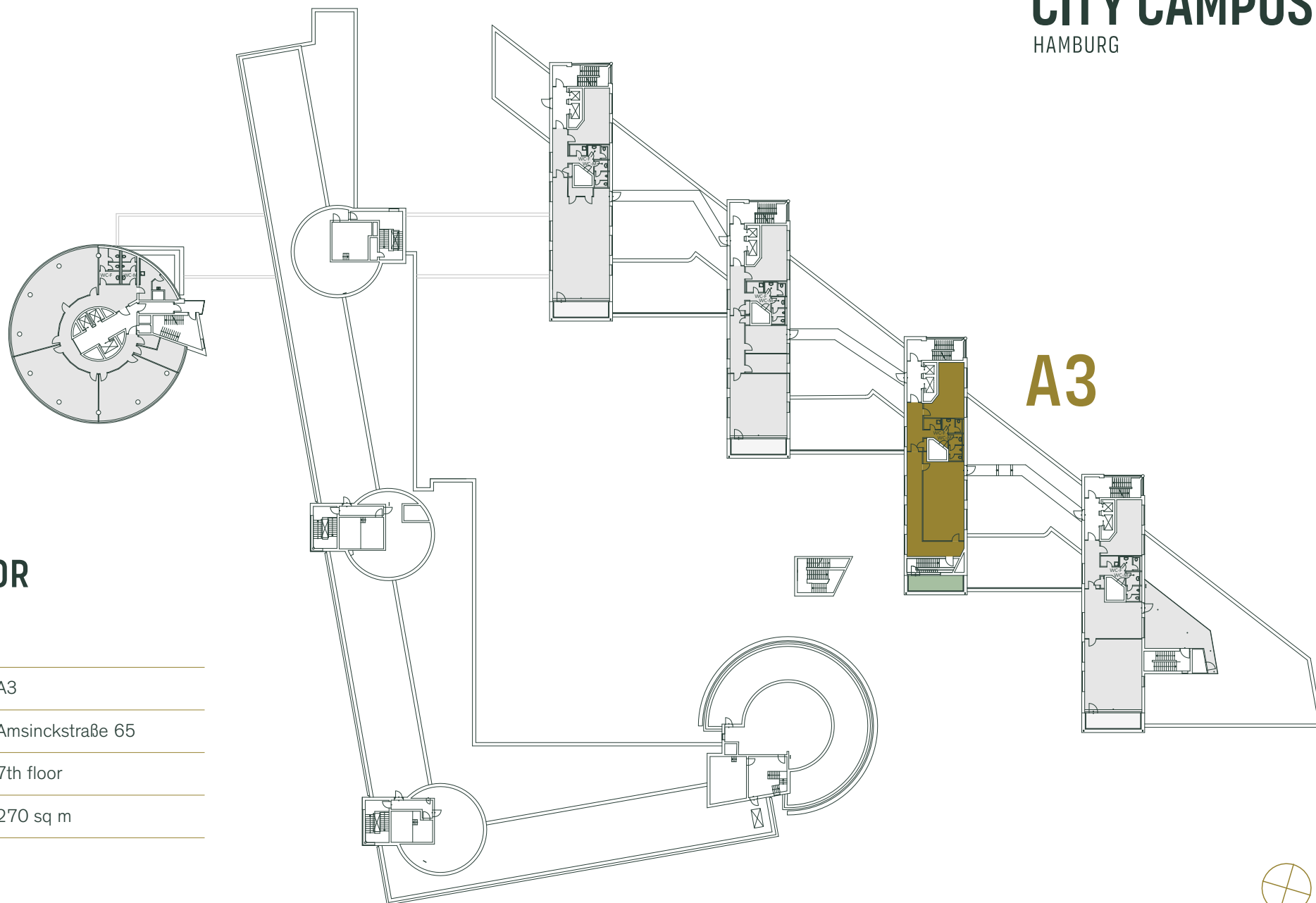



**CITY CAMPUS**  
HAMBURG

# FLOOR PLANS

**BUILDING A4, AVAILABLE SPACE: 4.735 SQ M**

## GROUND FLOOR BUILDING A

BUILDING	A4
ADDRESS	Amsinckstraße 71
FLOOR	Ground floor
SPACE	500 sq m

-  Lobby
-  Restaurant

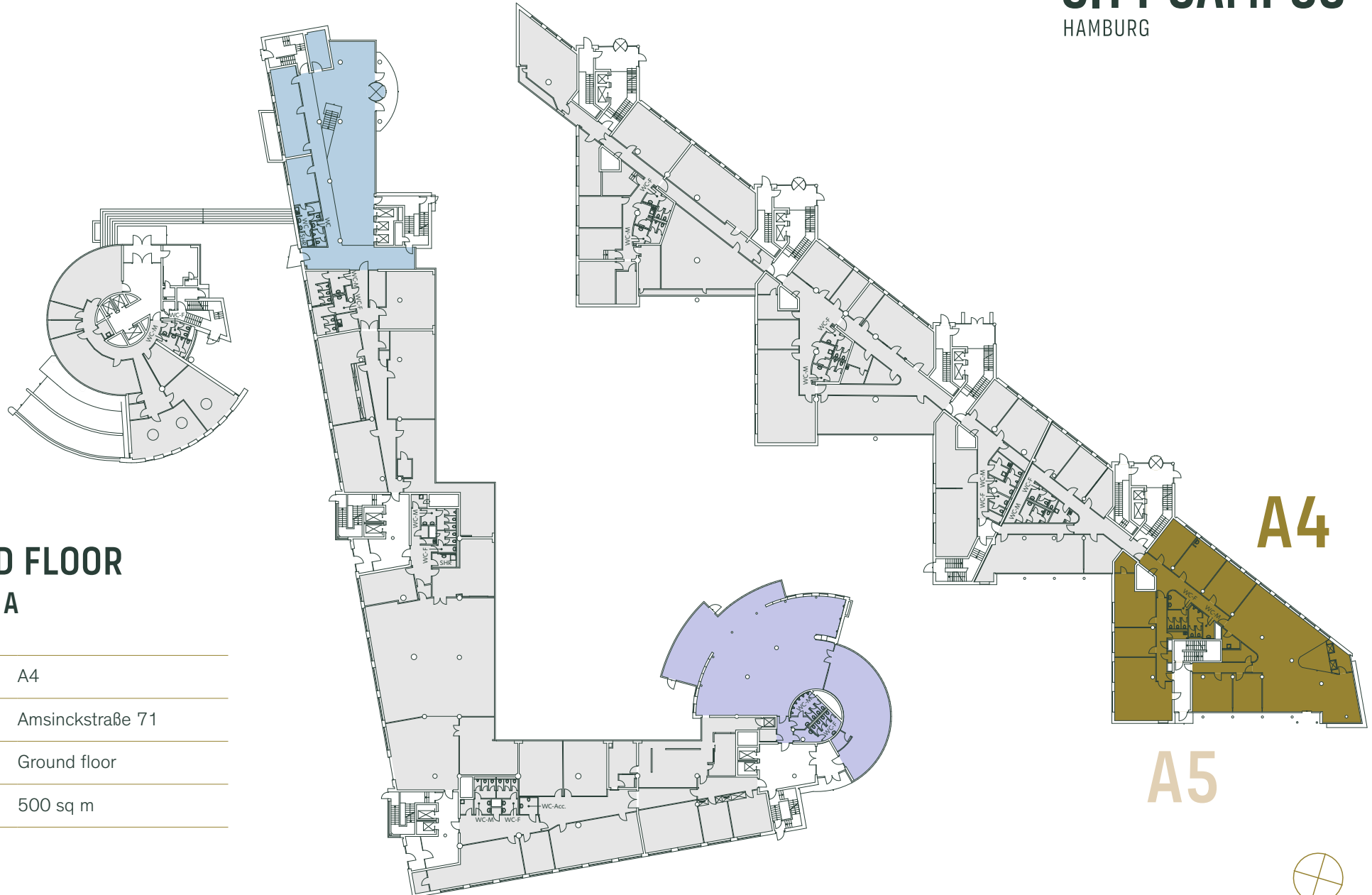



## TYPICAL FLOOR BUILDING A

BUILDING	A4
ADDRESS	Amsinckstraße 63
FLOOR	1st floor – 5th floor
SPACE	645 – 660 sq m

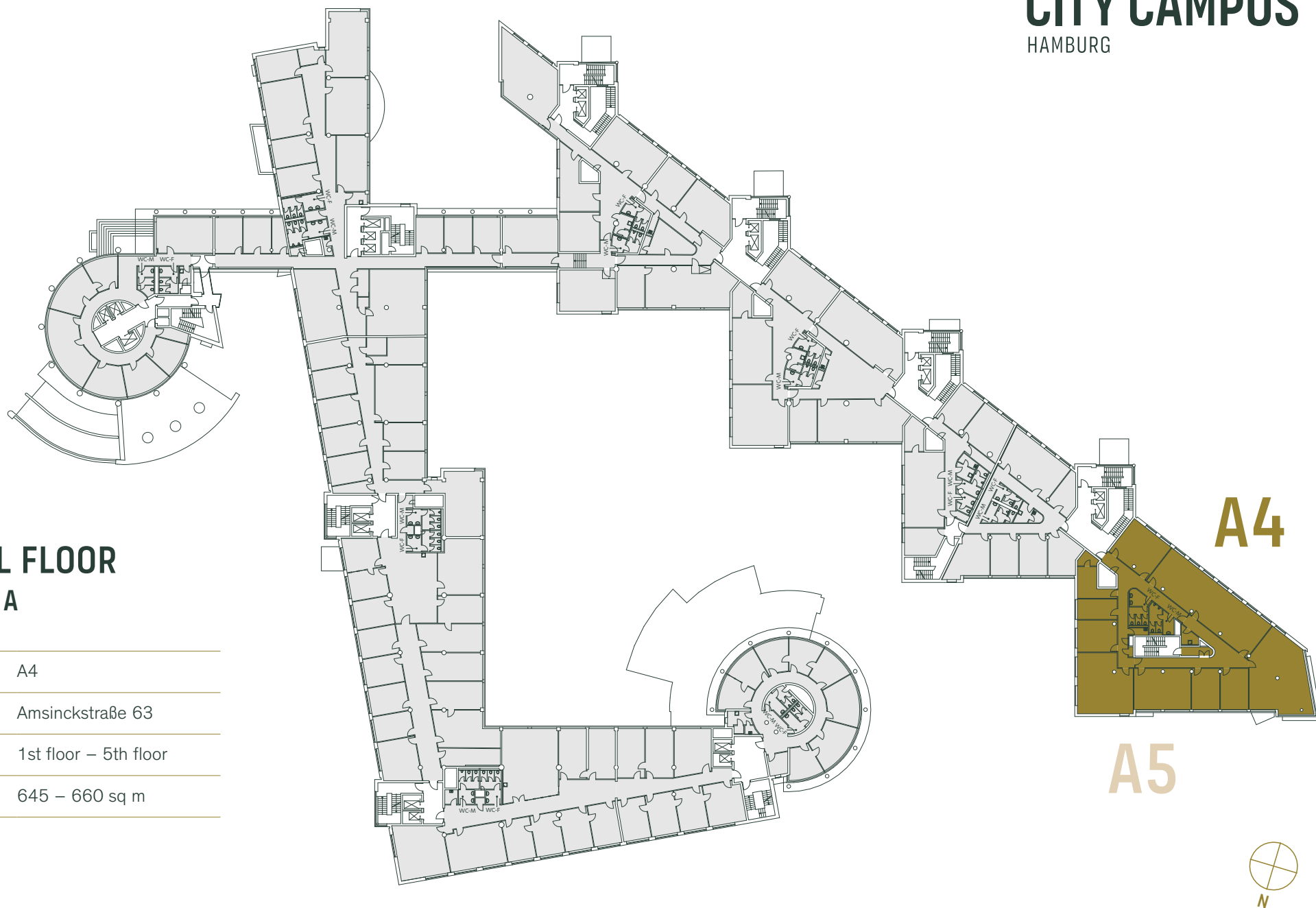

## 6TH FLOOR BUILDING A

BUILDING	A4
ADDRESS	Amsinckstraße 63
FLOOR	6th floor
SPACE	635 sq m

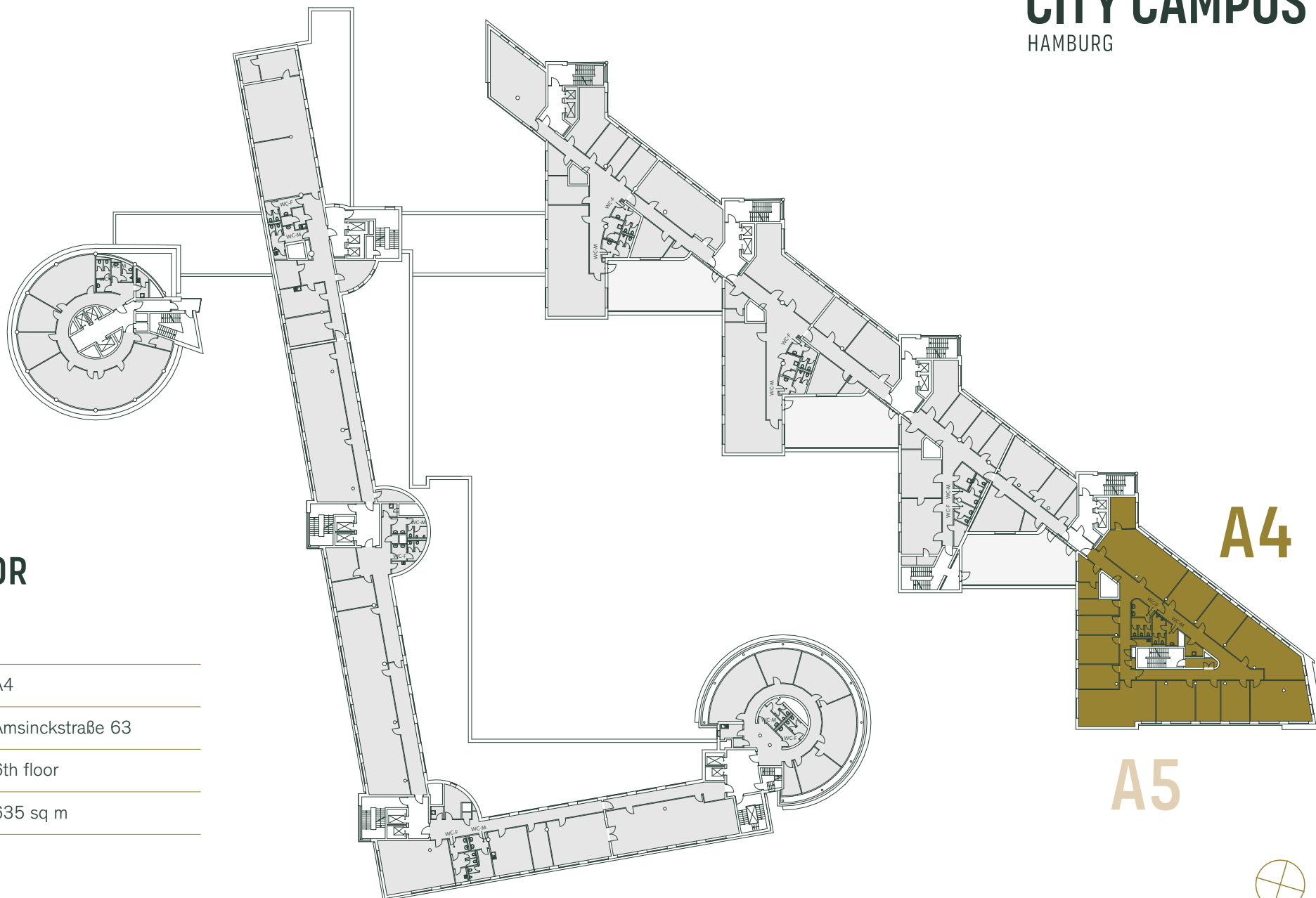

## 7TH FLOOR BUILDING A

BUILDING	A4
ADDRESS	Amsinckstraße 63
FLOOR	7th floor
SPACE	300 sq m

● Outdoor space

